



DoUVLEDs

DOWA SUPERB UV LED SOLUTIONS

MODEL xFxVL-1F111 series

T018 Flat Can Type



Mechanical Specifications and Materials (Unit: mm)

Product ID

265nm: DF7VL-1F111

280nm: DF8VL-1F111

310nm: UF1VL-1F111

325nm: UF3VL-1F111

340nm: UF4VL-1F111

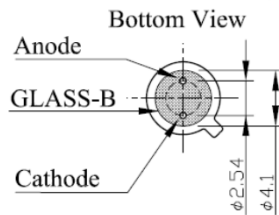
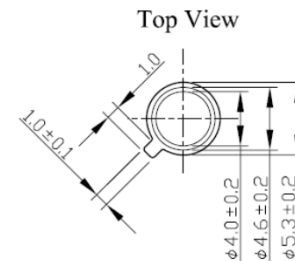
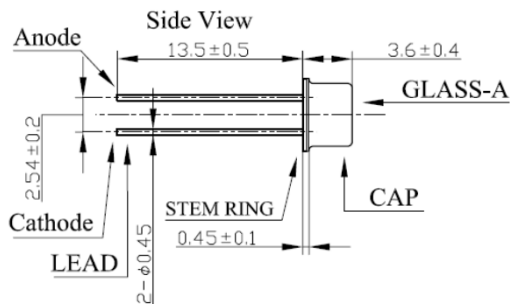

	ITEM	MATERIALS
1	GLASS-A	UV-GLASS
2	CAP	KOVAR, Ni Plating
3	STEM RING	KOVAR, Au Plating
4	GLASS-B	Hard Glass (Black)
5	LEAD	KOVAR, Au Plating

Typical Optical-Electrical Characteristics (I_F=20mA, T_a=25°C)

Item	Symbol	Unit	DF7VL	DF8VL	UF1VL	UF3VL	UF4VL
Peak Wavelength	λ_p	nm	265±5	280±10	310±5	325±5	340±5
Radiant Flux	P _o	mW	0.7	1.3	0.7	1.1	1.1
Full Width at Half Maximum	Δ	nm	13	12	15	11	9
Forward Voltage	V _F	V	8-9	6.5	6-7	4.5	4.0
Response*	rise time	t _r	ns	-	16	20	12
	fall time	t _f	ns	-	8	9	8
Viewing Half Angle	2θ _{1/2}	deg.	113	113	113	113	113

*Test condition : Frequency=100kHz, duty=1%, I_p=200mA

Absolute Maximum Ratings

Item	Symbol	Unit	Ambient Temperature	
Forward Current	I _{Fmax}	mA	40	T _a =25°C
Operating Temperature	T _{OPR}	°C	-30 ~ +80	
Storage Temperature	T _{STG}	°C	-40 ~ +100	
Soldering Temperature	T _{SOL}	°C	350 (within 3sec)	Manual soldering process
			250 (within 5sec)	Flow soldering process



DoUVLEDs

DOWA SUPERB UV LED SOLUTIONS

Forward Voltage vs Forward Current

Forward Current vs Radiant Flux

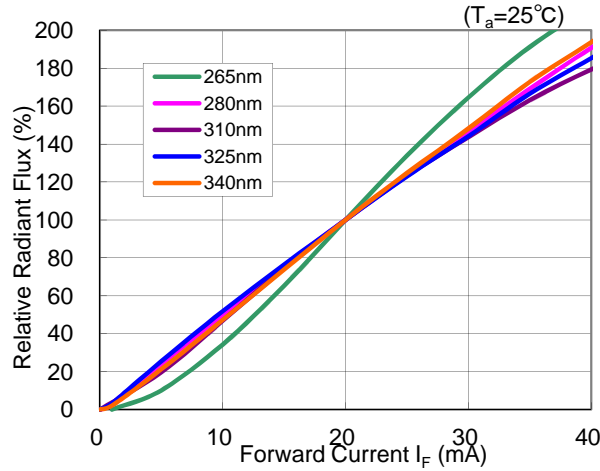
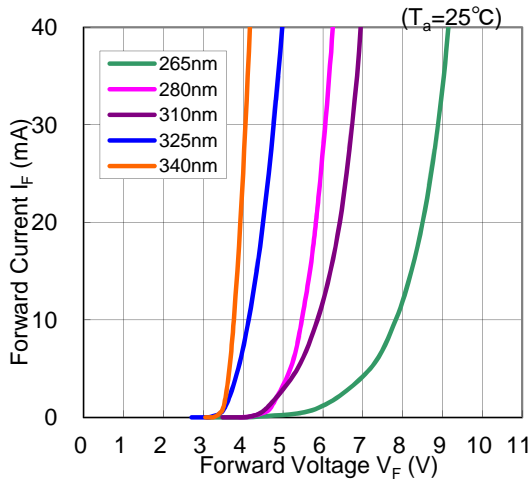

Peak Wavelength vs Relative Intensity

Radiation Pattern

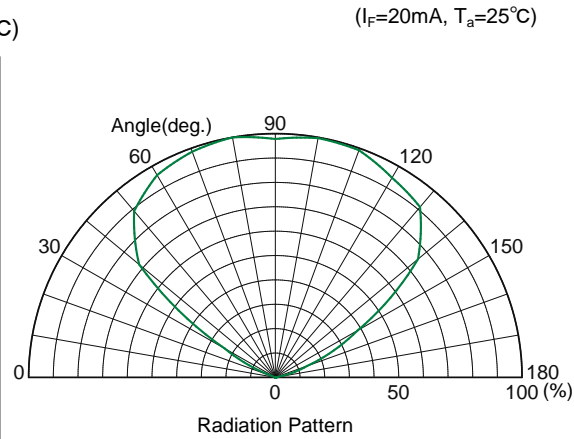
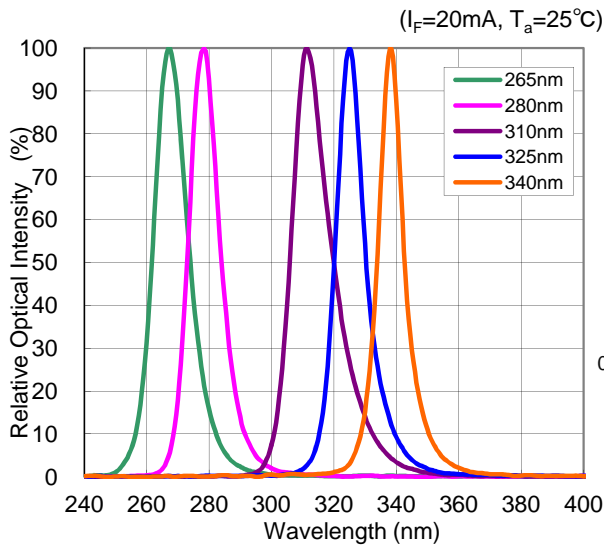

	⚠ WARNING
	<ul style="list-style-type: none"> • LEDs emit very strong UV radiation. • Don't look directly into the LED light. UV radiation can harm your eyes. • To prevent even inadequate exposure, wear protective eyewear. • If LEDs are embedded in devices, please indicate warning labels against the UV light LED used. • Keep out of reach of children. • Specification and dimension are subject to change for improvement without notice.

SPEC information (included design, dimension, and typical data) would be changed without prior notice.

[Japan] DOWA Electronics Materials Co., Ltd

Akihabara UDX Bldg. 4-14-1 Sotokanda, Chiyoda-ku, Tokyo 101-0021, Japan / Phone: +81-3-6847-1253

[USA] DOWA International Corp. San Jose office

4320 Stevens Creek Blvd. Suite 125, San Jose CA 95129, USA / Phone: +1-408-236-7560

[EU] DOWA HD Europe GmbH

Ostendstrasse 196, D-90482, Nurnberg, Germany / Phone: +49-911-56989-320

